



# How To Story-Rite™



The Story-Rite™ masonry story pole system solves the problem of building time consuming corner leads for the masonry process. The Story-Rite™ system sets the corner for plumb and height; quickly eliminating hours of labor. This self supporting story pole system uses a base that adjusts the wall for plumb and presets the height of the courses of block. It does not have any limits on height because it can be anchored to the block wall, which allows the mason to continue laying block as high as needed.

Set up of the Story-Rite™ system is quick and easy. Follow the steps below to properly set up Story-Rite™. After proper set up you can lay block quickly and efficiently; saving you time and money.

NOTE: See page 4 of this document for parts callout references in the steps.

**WARNING:** Be sure to anchor the Story-Rite™ poles securely to the wall when they are moved up the side of the wall for more height. Severe injury may occur if proper safety precaution is not taken.

## Step 1

Begin by laying out the wall lines on the poured concrete footings and snap the chalk lines. Line up the Base Plate (1) on the chalk lines at the corner of the footing. The flat Base Plate (1) includes multiple holes that are used for securing the base plate to a foundation footing. Fasten the base plate to the footing using 3 or more ¼" Tapcon screws.



## Step 2

On the Base Plate (1), there is a leveling pad (2) which is used for setting the height of the block courses. Using a laser level, shoot each pad and adjust up or down to the desired course height.



\*\*\* Starting point for 8" Poles \*\*\*  
Leveling pad top, 3 1/8" above grade (2 7/8" above base plate) adjust accordingly for unlevel footings.

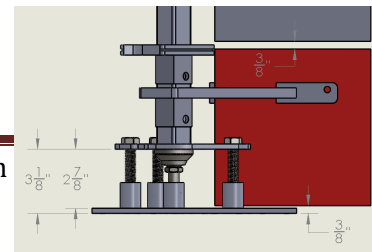

# How To Story-Rite

---

## Step 3

Slide appropriate plates and line blocks on Spacer Tube (6). Use Outside Corner Follower Plates (7) and Outside Line Blocks (9) for on an outside corner and use Inside Corner Follower Plates (8) and Inside Line Blocks (10) for an inside corner.



Outside Corner Followers and Line Blocks



Inside Corner Followers and Line Blocks

## Step 4

Set Spacer Tube (6) onto the Base Plate (1) centered on the Leveling Pad (2) and spin to lock it onto the 3 Bolts (3). Do not tighten Bolts (3) more than finger tight for now.



## Step 5

Slide the Inside (8) or Outside (7) Corner Follower Plate, depending on the type of corner you are doing, to the bottom of the Spacer Tube (6) for alignment purposes. Set a block on the footing (use two for an inside corner) with no mortar and line it up to the chalk line at the corner. This should contact the Base Plate (1). Now adjust the corner plate to the block by turning the Spacer Tube (6) until the corner plate is square to the block.



# How To Story-Rite

---

## Step 6

Using a level, plumb the pole on both sides by using the 3 Bolts (3) on the Base Plate (1).



## Step 7

Lower the corner plates (7,8) to the bottom of the pole. Lower the line block (9,10) to the lowest preset hole on the Spacer Tube (6) and insert a Line Block Pin (11) to secure it.



## Step 8

Do steps 1 through 7 on 3 or more poles and then run a mason line around each Spacer Tube in the slots on the Line Blocks (9,10) End the line at the pole by hooking onto the ears on the back of the Line Blocks (9,10).



## Step 9

Lay block to the line. When the course is complete unpin the Line Blocks (9,10) on each Spacer Tube (6) and slide up to the next preset hole (12) and reinsert the pin.

Slide the Corner Plates (7,8) up the Spacer Tube (6) as the block wall rises. This holds the Spacer Tube (6) plumb and takes the flex out of it. After 3 courses on an inside corner, slide up the Inside Corner Follower Plate (8) to the top of the last block laid. Set 2, 1/4 inch J bolts on top of the block and slide the threaded end into the holes provided. Thread the nuts on and adjust as necessary for plumb. These hook to the inside of the block and can be used over again as you go up. For an outside corner no anchoring of the Outside Corner Follower Plate (7) is necessary because the line tension pulls the Spacer Tube into the corner, just slide the corner plate up as each course is completed.

## How To Story-Rite

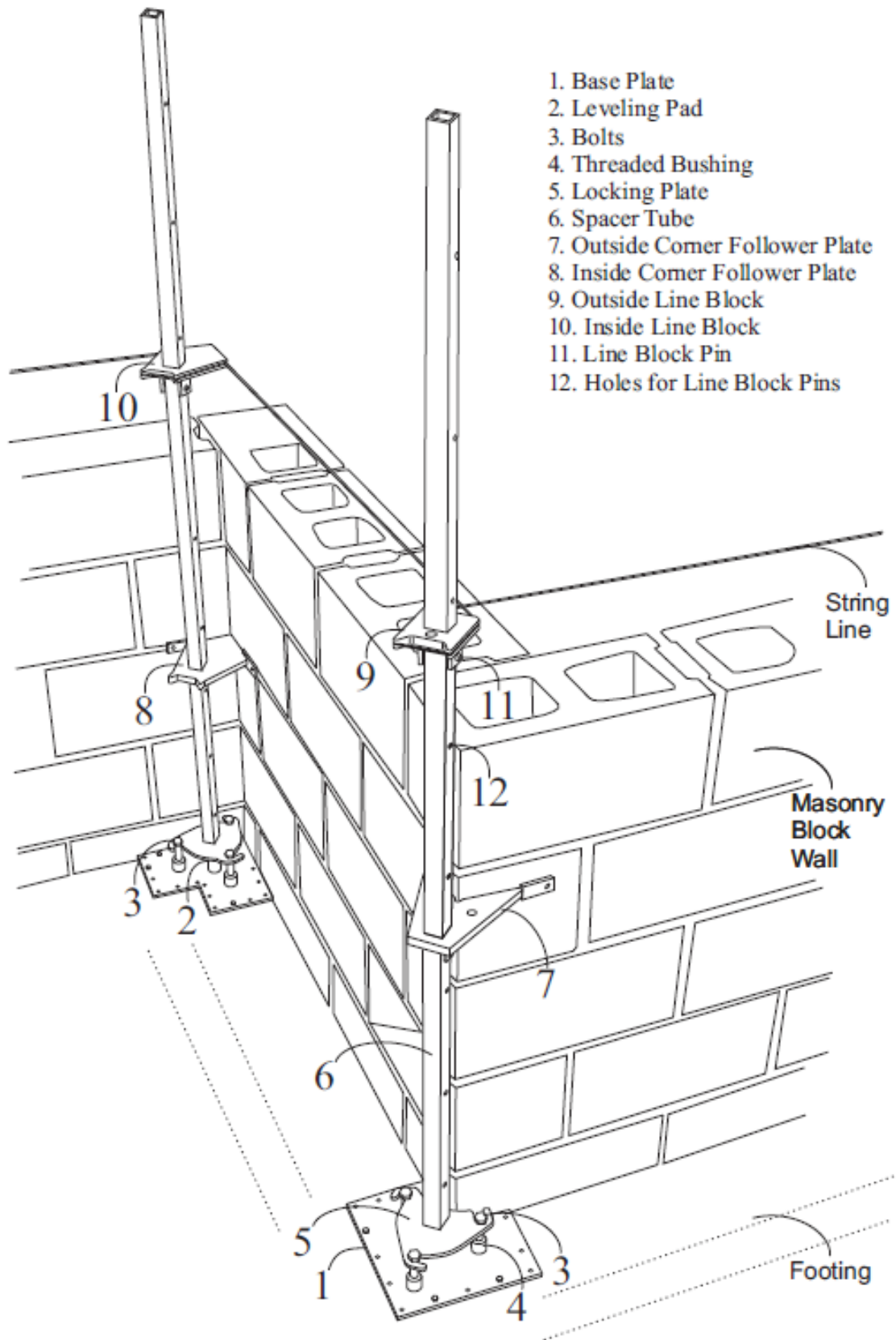

## How To Story-Rite

---

### **No Restriction on Height**

Just mount the Story-Rite™ masonry story poles to the block wall and keep on climbing!

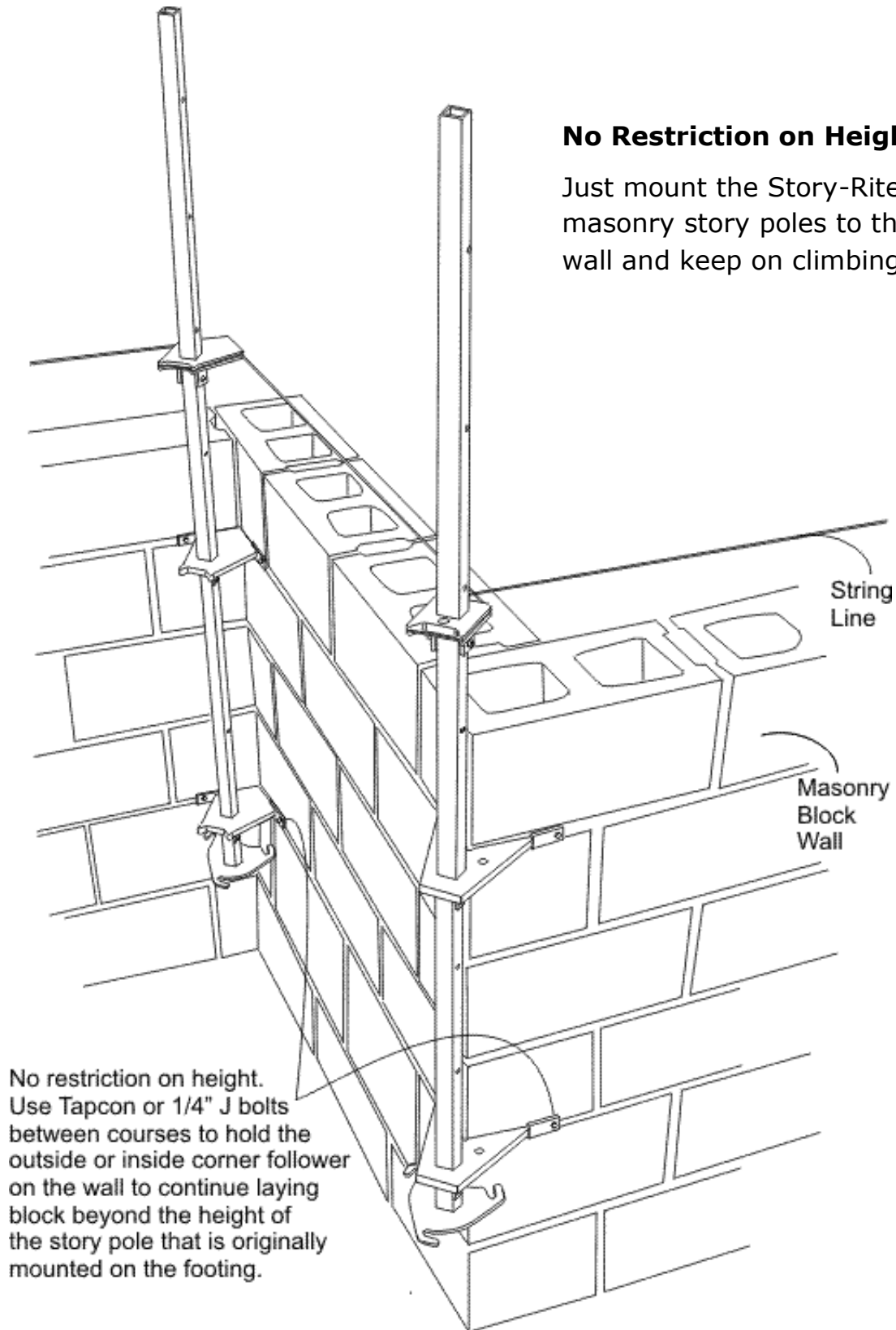

No restriction on height. Use Tapcon or 1/4" J bolts between courses to hold the outside or inside corner follower on the wall to continue laying block beyond the height of the story pole that is originally mounted on the footing.

## How To Story-Rite

### Job layout examples using the Story-Rite™ masonry story pole system.

A block foundation with several corners can be done with as few as 4 Story-Rite™ masonry story poles. Just set up the Story-Rite™ poles at 4 corners, lay the block for those walls, then move Story-Rite™ poles to other corners of the footing and lay block for those walls. Continue on to other corners by moving the Story-Rite™ poles until the foundation is complete.

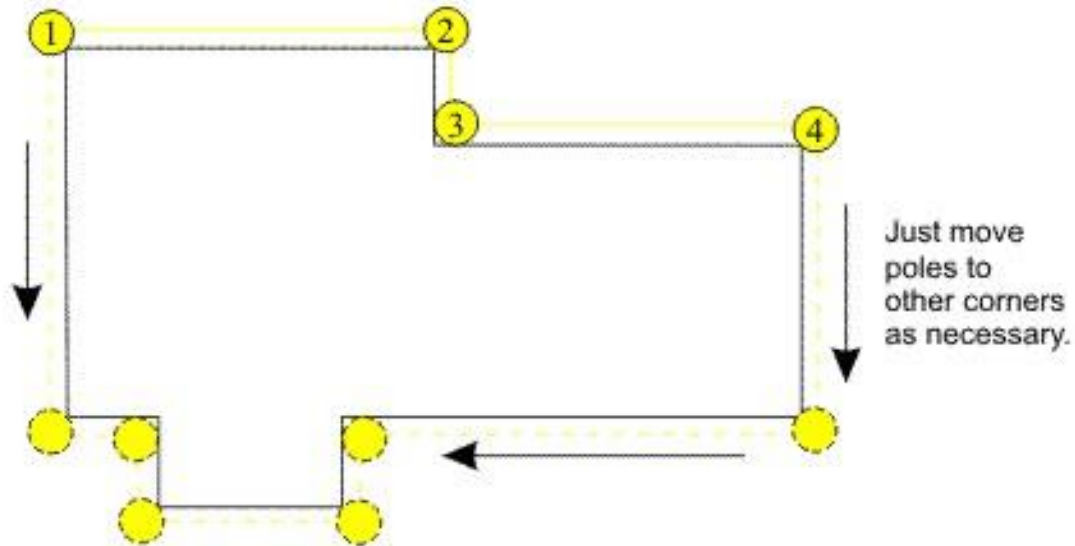

Or save the time and hassle by setting up Story-Rite™ masonry story poles at all the corners of the foundation.

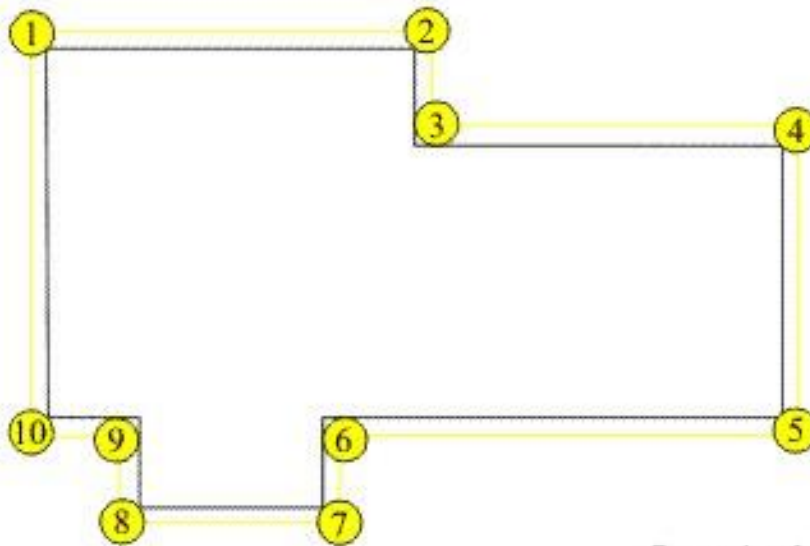

Superior Mason Products  
[www.SuperiorMason.com](http://www.SuperiorMason.com)



A Division of



Phone (906) 523-5638

[www.SuperiorMason.com](http://www.SuperiorMason.com)

